

P. C. B. Socket 2.0mm(0.079")

GXCON

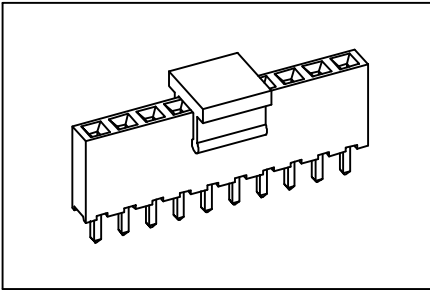

Material:

Housing: 30% Glass filled LCP UL94V-0.

Contacts: Phosphor Bronze.

Plating: Gold plated over nickel.

Tin plated over nickel.

Selective gold plated: Gold plated on mating area and tin plated on solder tail.

Electrical Characteristics:

Current Rating: 1 AMP.

Insulator Resistance: 5000MΩmin. at DC 500V.

Contact Resistance: 20mΩmax. at DC 100mA.

Operating Temperature: -65°C ~ +125°C.

Max Processing Temperature: 230°C for 30~60 seconds.

Features:

* Low profile 6.30mm(0.248")

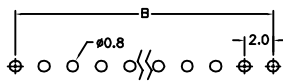
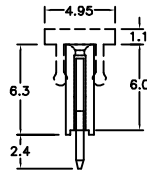
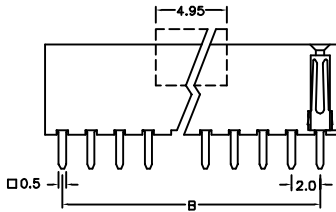
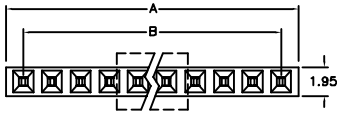

P.C. Board Layout

Position	4 Thru 40
Dimension	
A	2.0 X No. of Positions +0.4
B	2.0 X No. of Positions -1.0

Ordering information

PS14-	1	10	1	1	I	-	P1
Series	Single Row	No. of Pin Per Row	Gold Plated	Straight	T:Tape & Reel Package U:Tube Package		Blank:W/O Pad P1:Plastic Pad P2:Metal Pad P3:Tape Seal